

High Pressure Filter up to 60 bar

F445 / F465

Description	Compressed air filter for up to 60 bar operating pressure with various filter elements. Mounting in horizontal position, flow direction indicated by arrow.		
Filter element	5 µm and 40 µm made of sintered bronze, 0.01 µm coalescing filter made of borosilicate fibres with stainless steel jacket and foam protection		
Filtration efficiency	coalescing filter: 99.999% based on 0.01 µm particle size		
Bowl	metal version without sight glass		
Drainage	manual drain as standard		
Supply pressure	max. 60 bar		
Temperature range	0 °C to 90 °C / 32 °F to 194 °F, for appropriately conditioned compressed air down to -30 °C / -22 °F		
Material	Body: black, anodized aluminium	aluminium at G1½ and G2	
	Bowl: brass at G¾ to G1,		
	Elastomer: NBR/Buna-N		

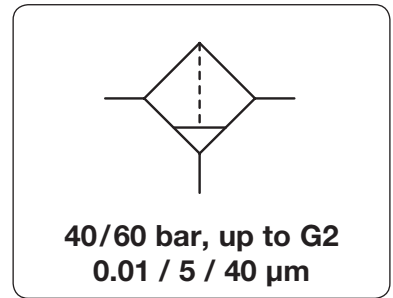

Dimensions			Bowl		Flow rate		Filter element	Connection	Order number
A	B	C	Design	Capacity	m³/h*1	l/min*1	µm	thread	
mm	mm	mm	made of / with	l				G	

High pressure filter up to 40 bar with manual drain, 99.999% at 0.01 µm **F445**

62	200	170	metal	0.08	160	2700	40	G¾*2	F445-03EL
					170	2800		G½	F445-04EL
80	210	165	metal	0.10	200	3300		G¾*2	F445-06EL
					210	3500		G1	F445-08EL
140	285	243	metal	0.30	1200	20000		G1½*2	F445-12EL
					1300	22000		G2	F445-16EL
62	200	170	metal	0.08	160	2700	5	G¾*2	F445-03GL
					170	2800		G½	F445-04GL
80	210	165	metal	0.10	160	2700		G¾*2	F445-06GL
					170	2800		G1	F445-08GL
140	285	243	metal	0.30	900	15000		G1½*2	F445-12GL
					1000	18000		G2	F445-16GL
62	200	170	metal	0.08	90	1500	0.01	G¾*2	F445-03IL
					100	1600		G½	F445-04IL
80	210	165	metal	0.10	145	2300		G¾*2	F445-06IL
					150	2500		G1	F445-08IL



F445-08EL, 40 bar

High pressure filter up to 60 bar with manual drain, 99.999% at 0.01 µm **F465**

65	185	160	metal	0.08	160	2700	40	G¾*2	F465-03EL
					170	2800		G½	F465-04EL
80	200	170	metal	0.10	354	5900		G¾*2	F465-06EL
					360	6000		G1	F465-08EL
65	185	160	metal	0.08	160	2700	5	G¾*2	F465-03GL
					170	2800		G½	F465-04GL
80	200	170	metal	0.10	264	4400		G¾*2	F465-06GL
					270	4500		G1	F465-08GL
65	185	160	metal	0.08	90	1500	0.01	G¾*2	F465-03IL
					100	1600		G½	F465-04IL
80	200	170	metal	0.10	132	2200		G¾*2	F465-06IL
					138	2300		G1	F465-08IL



F465-08EL, 60 bar

Special options, add the appropriate letter

for oxygen specially cleaned **F4.5-...15**

Accessories, enclosed

mounting bracket made of steel for G¾ and G½ **BW00-15**
for G¾ and G1 **BW00-16**

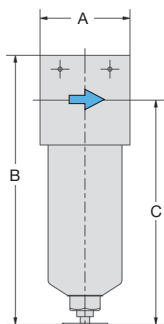

F445 / F465

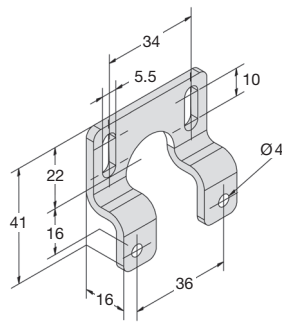

BW00-15

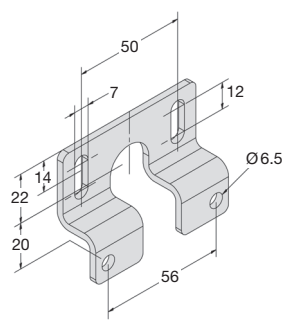

BW00-16

*1 at 7 bar operating pressure and 0.33 bar pressure drop

*2 reduced from the next bigger filter size

Spare parts: see separate spare parts list

PDF CAD
www.aircom.net



Order example:
F445-03EL